

BLACK'S FORT

Black's Fort

Black's Fort was built as a stockade and ammunition store in 1855 by William Black for the defense of area settlers from Indian attack. It was abandoned in 1868. The ruins are on private land called Black's Fort Ranch and can be seen from the State historical marker by the road.

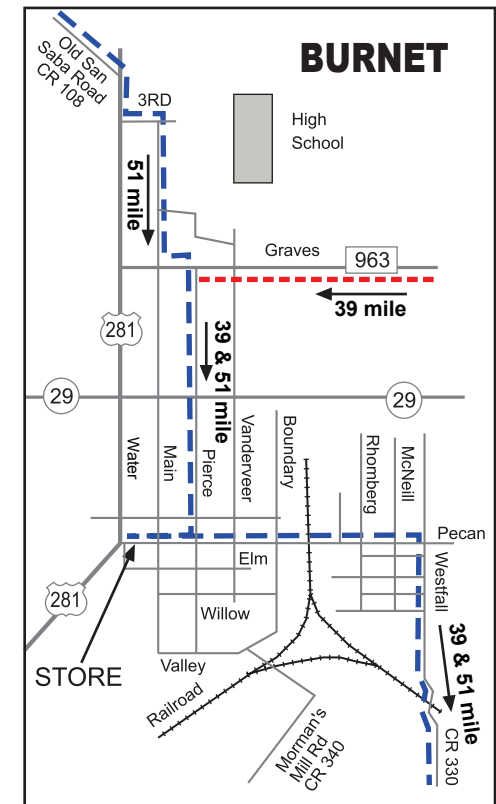
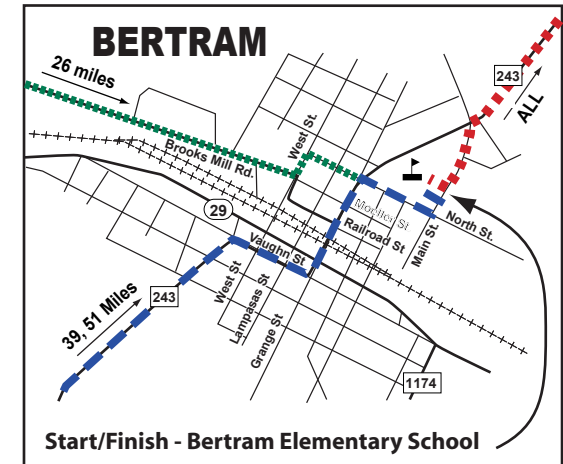
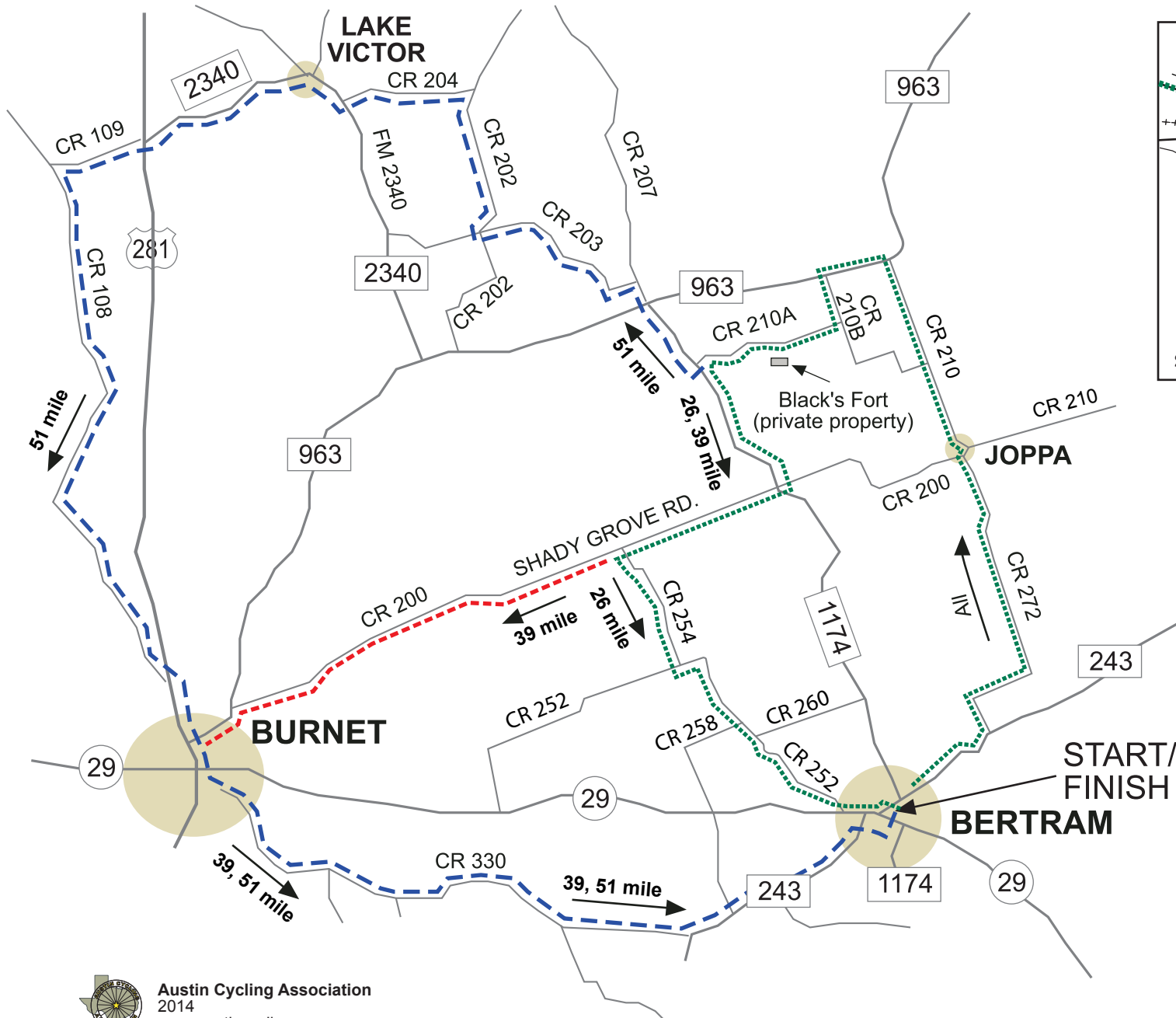

Austin Cycling Association
2014
www.austincycling.org

26 Mile Loop

0.0	0.0	LT out of school parking lot
0.1	0.1	RT onto FM 243
1.7	1.8	LT onto CR 272
5.2	7.0	RT onto CR 200/CR 210
0.1	7.1	LT onto CR 210 (at church in Joppa)
3.1	10.2	LT onto FM 963
1.0	11.2	LT onto CR 210B
0.6	11.8	RT onto CR 210A
0.9	12.7	BLACK'S FORT on left
1.5	14.2	LT onto FM 1174
2.1	16.3	RT onto CR 200/Shady Grove Rd
2.5	18.8	LT onto CR 254/Brooks Mill Rd
2.2	21.0	LT onto CR 252
4.2	25.2	LT onto N West St
0.1	25.3	RT onto North St
0.3	25.6	LT onto Main St
0.1	25.7	FINISH

39 Mile Loop

0.0	0.0	LT out of school parking lot
0.1	0.1	RT onto FM 243
1.7	1.8	LT onto CR 272
5.2	7.0	RT onto CR 200/CR 210
0.1	7.1	LT onto CR 210 (at church in Joppa)
3.1	10.2	LT onto FM 963
1.0	11.2	LT onto CR 210B
0.6	11.8	RT onto CR 210A
0.9	12.7	BLACK'S FORT on left
1.5	14.2	LT onto FM 1174
2.1	16.3	RT onto Co Rd 200/ Shady Grove Rd
9.1	25.4	LT onto Graves/FM 963
0.2	25.6	LT onto N. Pierce St.
0.7	26.3	Cross SH 29
0.4	26.7	RT onto W. Pecan St.
0.1	26.8	STORE (return on Pecan after store stop)
0.6	27.4	RT onto Westfall (CR 330)
7.9	35.3	LT onto FM 243
3.3	38.6	RT onto Vaughn ST.
0.2	38.8	LT onto Grange St.
0.1	38.9	Cross Hwy 29
0.2	39.1	RT onto North St.
0.2	39.3	LT onto Main St.
0.1	39.4	FINISH

51 Mile Loop

0.0	0.0	LT out of school parking lot
0.1	0.1	RT onto FM 243
1.7	1.8	LT onto CR 272
5.2	7.0	RT onto CR 200/CR 210
0.1	7.1	LT onto CR 210 (at church in Joppa)
3.1	10.2	LT onto FM 963
1.0	11.2	LT onto CR 210B
0.6	11.8	RT onto CR 210A
0.9	12.7	BLACK'S FORT on left
1.5	14.2	RT onto FM 1174
1.3	15.5	Cross FM 963 turns into CR 207
0.4	15.9	LT onto CR 203
2.9	18.8	RT onto CR 202
2.3	21.1	LT onto CR 204
2.1	23.2	RT onto FM 2340
0.5	23.7	Pass through Lake Victor
2.8	26.5	Cross US 281 onto CR 109
1.4	27.9	LT onto CR 108
8.8	36.7	RT onto US 281
0.2	36.9	LT onto 3rd St.
0.1	37.0	RT onto N. Main St
0.5	37.5	LT onto Graves/FM 963
0.1	37.6	RT onto N. Pierce St.
0.7	38.3	Cross SH 29
0.4	38.7	RT onto W. Pecan St.
0.1	38.8	STORE (return on Pecan after store stop)
0.6	39.4	RT onto Westfall (CR 330)
7.9	47.3	LT onto FM 243
3.3	50.6	RT onto Vaughn ST.
0.2	50.8	LT onto Grange St.
0.1	50.9	Cross Hwy 29
0.2	51.1	RT onto North St.
0.2	51.3	LT onto Main St.
0.1	51.4	FINISH

BLACK'S FORT



Austin Cycling Association
2014
www.austincycling.org